

Instruction Sheet

Sensor Insertion (Ball Valve) Mounting¹

Introduction

The sensor insertion assembly allows the insertion and extraction of a sensor from a pressurized process line without stopping flow in the pipe. Install as follows:

1. Remove the cable strain relief cap and split rubber grommet. See [Figure 2](#).
2. Loosen the allen head/phillips head cap screws on the retaining clamp and unscrew the retaining cap. See [Figure 1](#).
3. Unscrew the lock ring to remove the insert/extract shaft assembly from the assembled insertion hardware. See [Figure 1](#).
4. Route the sensor cable through the shaft assembly and out the body of the strain relief.
5. Place the split rubber sealing grommet over the sensor cable. Slide the grommet along the sensor cable and into the strain relief body. Route the sensor cable through the top of the strain relief. Slide the top of the strain relief along the sensor cable and loosely screw it onto the strain relief body. See [Figure 2](#).
6. Apply Teflon tape to the sensor threads at the cable end to avoid leaks (pipe sealant with Teflon®, Locktite No. 59321 or equivalent, may not provide adequate sealing at higher solution temperatures). Fasten the sensor onto the shaft assembly. See [Figure 3](#).
7. Pull any excess cable through the strain relief and tighten.
8. Connect the sensor cable to the controller. See the analyzer operation manual for additional information on connecting the sensor to the controller.

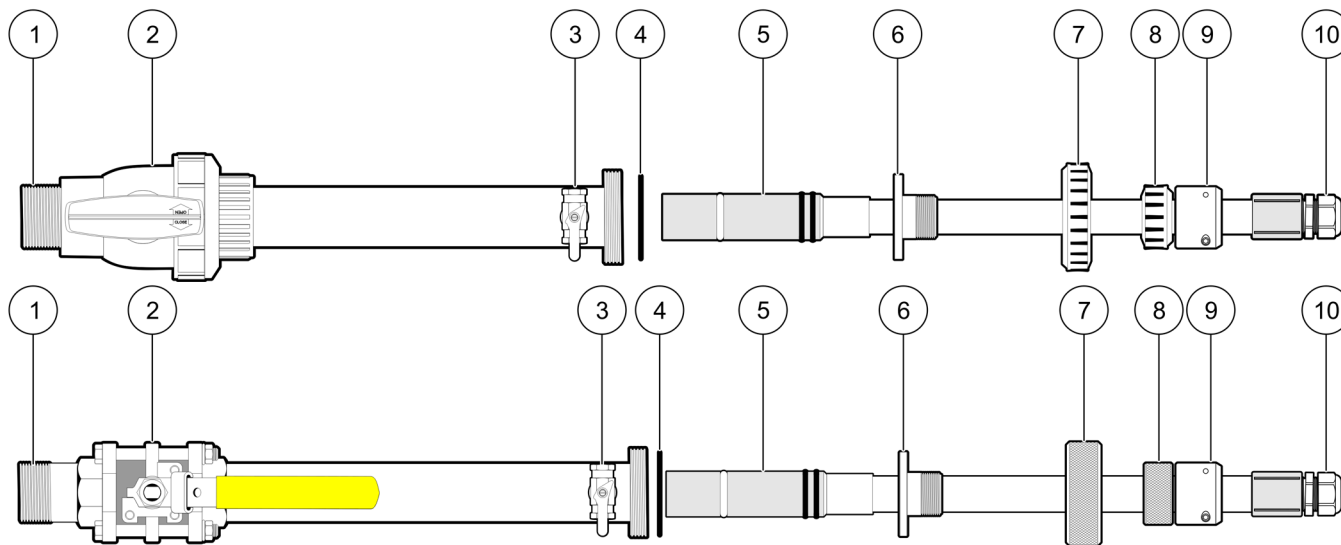

Figure 1 CPVC and Stainless Steel Insertion Mounting Hardware

1	Nipple, 1-½ inch NPT	6	Sealing hub
2	Ball valve, 1-½ inch NPT	7	Lock ring
3	Air-assist, control valve, brass	8	Cap, retaining
4	O-Ring	9	Clamp, retaining
5	Shaft assembly	10	Strain relief, cable

¹ Works with multiple parameter sensors

Sensor Insertion (Ball Valve) Mounting

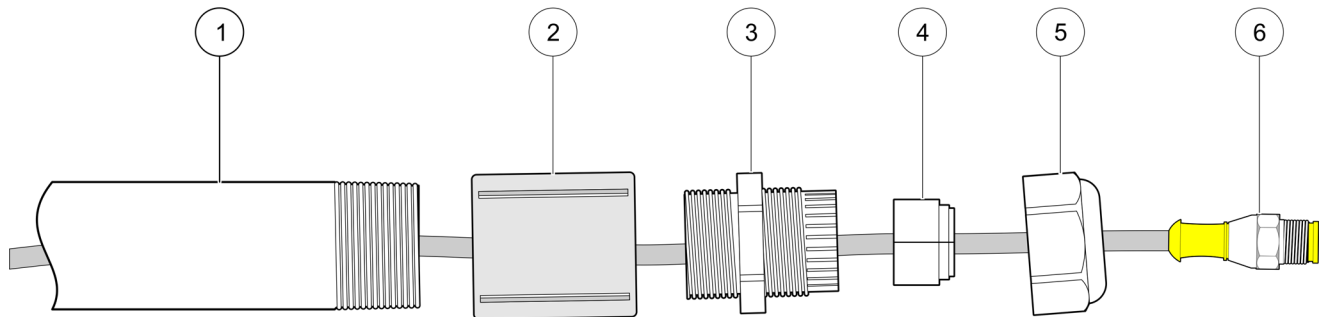

Figure 2 Assembling the Strain Relief and Coupling

1	Shaft assembly	4	Grommet, split rubber
2	Coupling	5	Strain relief
3	Strain relief body	6	Connector, sensor, digital

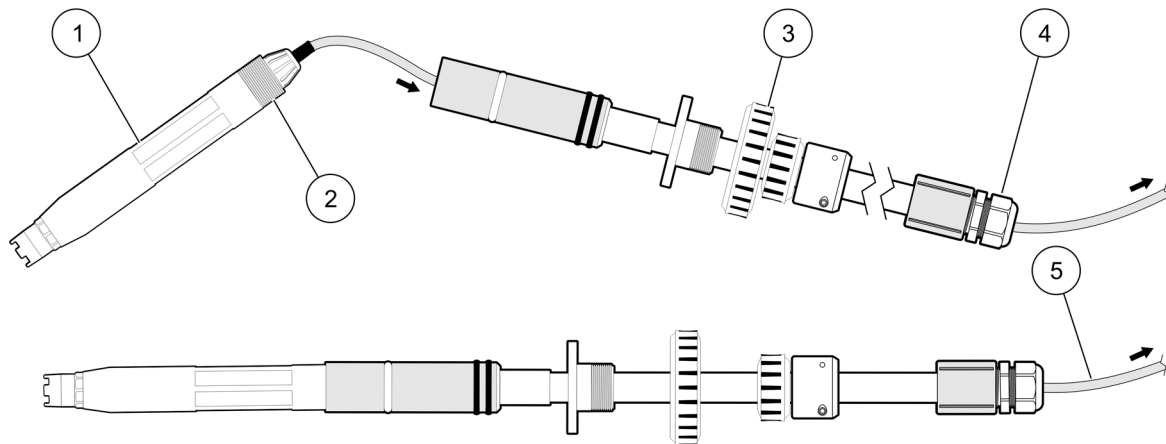

Figure 3 Attaching sensor to shaft assembly

1	Sensor (may look different depending on the sensor)	4	Strain relief
2	Apply teflon tape to threads. Insert sensor as shown.	5	Pull excess cable and tighten strain relief
3	Lock ring		

Setting the Sensor Insertion Depth

The sensor insertion depth is the distance that the sensor salt bridge extends beyond the threaded nipple of the ball valve assembly (see [Figure 4](#)). The maximum insertion depth is 114 mm (4.5 inches). If this insertion depth is acceptable for the application, disregard the following procedure and mount the ball valve assembly in the non-pressurized process pipe/vessel. To reduce the insertion depth, complete the following procedure:

1. Loosen the screws on the retaining clamp and unscrew the retaining cap. See [Figure 4](#).
2. Adjust the insertion depth of the sensor by sliding the shaft assembly in the retaining clamp to the appropriate depth.
3. Tighten the retaining clamp screws. Lightly score the shaft assembly pipe just above the clamp for future insertion depth reference.

Note: Do not reduce the insertion depth to less than 25 mm (1 inch). Optimum sensor performance depends upon the sensor electrode and salt bridge being fully immersed in the process.

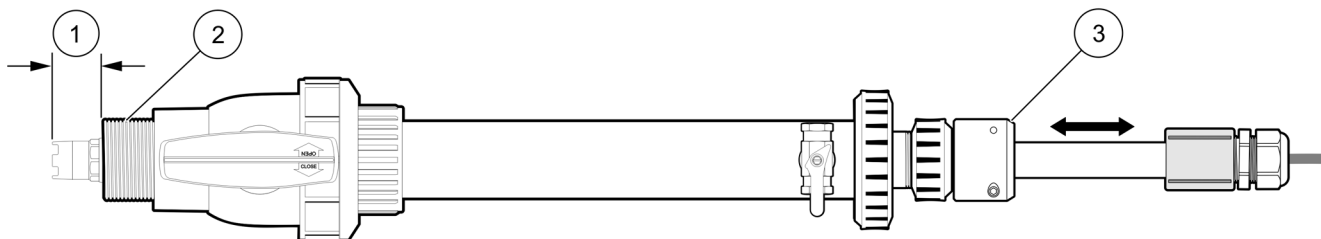

Figure 4 Sensor Insertion Depth

1	Sensor insertion depth	2	Nipple, 1-½ inch NPT	3	Clamp, retaining
---	------------------------	---	----------------------	---	------------------

Mounting the Ball Valve in a Non-pressurized Pipe/Vessel

With the shaft assembly removed, mount the ball valve hardware in a portion of the process pipe or vessel where air cannot be trapped and contact the sensor electrode.

Note: Allow 10 pipe diameters upstream and 5 pipe diameters downstream to minimize turbulence effects at the sensor.

1. Apply Teflon tape to the 1-½ inch NPT nipple to avoid leaks (see [Figure 1](#)).
Note: Pipe sealant with Teflon, Loctite No. 59321 or equivalent, may not provide adequate sealing at higher solution temperatures.
2. Fasten the 1-½ inch ball valve into the non-pressurized pipe or vessel at the desired location. The mounting hardware must be at least 15° above horizontal.
3. Turn the ball valve to its full OPEN position.
4. Connect a ¼-inch air or water-assist line to the ¼-inch NPT fitting of the brass control valve on the ball valve hardware. Turn this control valve to its center OFF position (see [Figure 5](#)).

CAUTION

The air or water line pressure must be greater than the process pressure, but cannot exceed 120 psi.

5. Connect a drain line to the fitting on the other side of the control valve (see [Figure 5](#)).

Installing Sensor into a Non-pressurized Ball Valve Hardware

After connecting the sensor cable to the analyzer, setting the insertion depth (if needed), and mounting the ball valve, install the sensor into the non-pressurized process pipe or vessel.

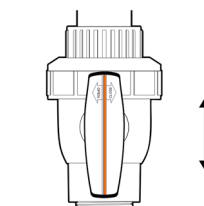

1. Remove the protective cap from the sensor. Retain the cap to protect the electrode and sensor when the sensor is temporarily removed from service.
2. Before installing the sensor, calibrate the system as described in the analyzer operation manual.
3. After calibration, apply a small amount of silicone grease to the two small, brown O-rings on the shaft assembly located behind the sensor.
4. With the ball valve open, fully insert the sensor into the ball valve hardware by pushing it in the shaft assembly to its limit.



Sensor Insertion (Ball Valve) Mounting

5. With the Viton O-ring properly seated in its groove, tighten the lock ring to secure the shaft assembly to the ball valve hardware.
6. Tighten the retaining cap onto the flanged bushing.
7. Pull the shaft assembly outward to its limit to fully extract the sensor from the ball valve hardware.
8. Turn the ball valve to its CLOSED position. The process pipe or vessel can now be pressurized.

Inserting the Sensor into a Pressurized Pipe or Vessel

DANGER

Inserting a sensor into a pressurized process pipe or vessel may be dangerous. Do not stand directly behind the assembly when opening the ball valve. Depending on the process pressure, the shaft assembly may rapidly travel outward until it is stopped by the lock ring.

After installing the sensor into the ball valve hardware, the sensor can be inserted into a pressurized process pipe or vessel.

1. Slowly turn the ball valve to its full OPEN position (see [Figure 5](#)).
2. With the air or water-assist line at a pressure higher than the process but not exceeding 120 psi, slowly turn the brass control valve to its full INSERTION position. The sensor will begin moving into the process pipe or vessel.
3. When the sensor reaches the preset insertion depth as identified by the score mark on the shaft, turn the brass control valve to OFF.
4. Tighten the screws on the retaining clamp.

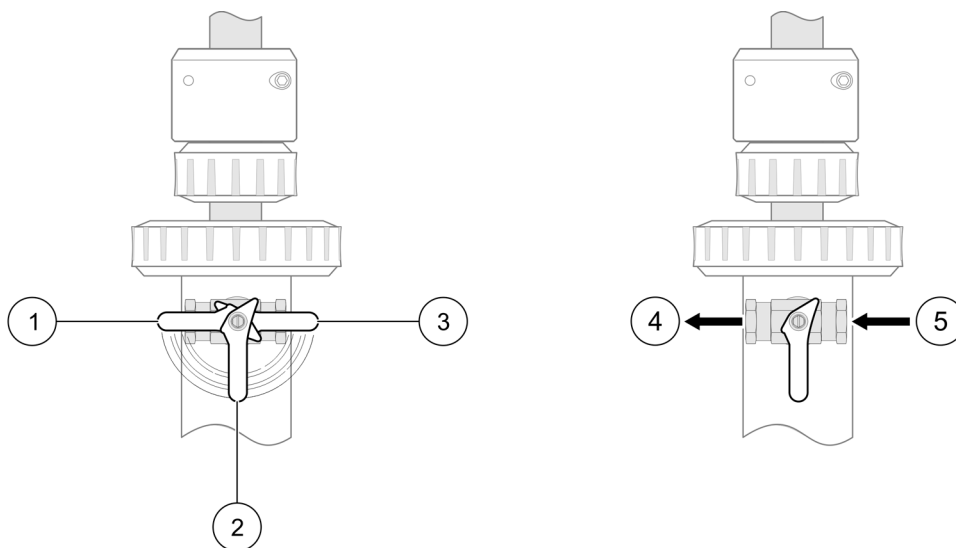

Figure 5 Inserting the Sensor into a Pressurized Pipe/Vessel

1	Position one, sensor EXTRACTION.	4	Air or water assist supply, OUT (drain)
2	Position two, OFF.	5	Air or water assist supply, IN
3	Position three, sensor INSERTION.		

Extracting the Sensor from a Pressurized Pipe or Vessel

DANGER

Extracting a sensor from a pressurized process pipe or vessel may be dangerous. Do not stand directly behind the insertion assembly when removing the retaining cap. Reduce the process pressure to below 10 psi before extracting the sensor. If this is not possible, use extreme caution. At higher pressures, the shaft assembly may travel rapidly to its maximum outward position and injure anyone in its path.

With air or water pressure supplied to the insertion hardware assembly, use the brass control valve to extract the sensor from the process.

1. Loosen the screws on the retaining clamp.
2. Slowly turn the brass control valve to its full EXTRACTION position. See [Figure 5](#). Permit the shaft assembly to move to its maximum outward travel. This ensures that the sensor electrode has cleared the ball valve opening.
3. With the shaft assembly fully extended, place the brass control valve to the OFF position, and immediately turn the ball valve to the full CLOSED position.

To remove the sensor for routine maintenance and calibration:

1. Loosen and remove the lock ring from the ball valve hardware.
2. Pull to extract the shaft assembly from the ball valve hardware.

Replacement Parts

Description	Quantity	Catalog Number
Cap, retaining, for PVC assemblies	1	5977100
Cap, retaining, for stainless steel assemblies	1	5977600
Clamp, retaining, half, for analog PVC assemblies	1	5977500
Clamp, retaining, half, for analog stainless steel assemblies	1	5977400
Clamp, retaining, half, for digital PVC assemblies	1	5977300
Clamp, retaining, half, for digital stainless steel assemblies	1	5977200
Coupling, for analog PVC assemblies	1	3P2120-103
Coupling, for analog stainless steel assemblies	1	2P2220-103
Coupling, for digital assemblies	1	6138600
Hex nut, for PVC assemblies	1	SE 504
Lock ring, for PVC assemblies	1	60F1020-101
Lock ring, for stainless steel assemblies	1	60B3F1020-102
O-ring, Viton	1	5H1233
Sealing hub, for analog PVC assemblies	1	60F1022-103
Sealing hub, for analog stainless steel assemblies	1	60B3F1020-102
Sealing hub, for digital PVC assemblies	1	6138200
Sealing hub, for digital stainless steel assemblies	1	6138300
Screw, retaining clamp, Phillips head	1	561711
Screw, retaining clamp, Allen head	1	SE 518
Strain relief, digital cable assemblies	1	6128701
Strain relief, analog cable assemblies	1	3H1091

Contact Information

HACH Company World Headquarters

P.O. Box 389
Loveland, Colorado
80539-0389 U.S.A.
Tel (800) 227-HACH
(800) -227-4224
(U.S.A. only)
Fax (970) 669-2932
orders@hach.com
www.hach.com

Repair Service in the United States:

HACH Company
Ames Service
100 Dayton Avenue
Ames, Iowa 50010
Tel (800) 227-4224
(U.S.A. only)
Fax (515) 232-3835

Repair Service in Canada:

Hach Sales & Service
Canada Ltd.
1313 Border Street, Unit 34
Winnipeg, Manitoba
R3H 0X4
Tel (800) 665-7635
(Canada only)
Tel (204) 632-5598
Fax (204) 694-5134
canada@hach.com

Repair Service in Latin America, the Caribbean, the Far East, Indian Subcontinent, Africa, Europe, or the Middle East:

Hach Company World
Headquarters,
P.O. Box 389
Loveland, Colorado,
80539-0389 U.S.A.
Tel +001 (970) 669-3050
Fax +001 (970) 669-2932
intl@hach.com

HACH LANGE GMBH

Willstätterstraße 11
D-40549 Düsseldorf
Tel. +49 (0)2 11 52 88-320
Fax +49 (0)2 11 52 88-210
info@hach-lange.de
www.hach-lange.de

HACH LANGE LTD

Pacific Way
Salford
GB-Manchester, M50 1DL
Tel. +44 (0)161 872 14 87
Fax +44 (0)161 848 73 24
info@hach-lange.co.uk
www.hach-lange.co.uk

HACH LANGE LTD

Unit 1, Chestnut Road
Western Industrial Estate
IRL-Dublin 12
Tel. +353(0)1 46 02 5 22
Fax +353(0)1 4 50 93 37
info@hach-lange.ie
www.hach-lange.ie

DR. BRUNO LANGE GES. MBH

Industriestraße 12
A-3200 Obergrafendorf
Tel. +43 (0)27 47 74 12
Fax +43 (0)27 47 42 18
info@hach-lange.at
www.hach-lange.at

DR. BRUNO LANGE AG

Juchstrasse 1
CH-8604 Hegnau
Tel. +41(0)44 9 45 66 10
Fax +41(0)44 9 45 66 76
info@hach-lange.ch
www.hach-lange.ch

HACH LANGE FRANCE S.A.S.

33, Rue du Ballon
F-93165 Noisy Le Grand
Tél. +33 (0)1 48 15 68 70
Fax +33 (0)1 48 15 80 00
info@hach-lange.fr
www.hach-lange.fr

HACH LANGE SA

Motstraat 54
B-2800 Mechelen
Tél. +32 (0)15 42 35 00
Fax +32 (0)15 41 61 20
info@hach-lange.be
www.hach-lange.be

DR. LANGE NEDERLAND B.V.

Laan van Westroijen 2a
NL-4003 AZ Tiel
Tel. +31(0)344 63 11 30
Fax +31(0)344 63 11 50
info@hach-lange.nl
www.hach-lange.nl

HACH LANGE APS

Åkandevej 21
DK-2700 Brønshøj
Tel. +45 36 77 29 11
Fax +45 36 77 49 11
info@hach-lange.dk
www.hach-lange.dk

HACH LANGE AB

Vinhundsvägen 159A
SE-128 62 Sköndal
Tel. +46 (0)8 7 98 05 00
Fax +46 (0)8 7 98 05 30
info@hach-lange.se
www.hach-lange.se

HACH LANGE S.R.L.

Via Riccione, 14
I-20156 Milano
Tel. +39 02 39 23 14-1
Fax +39 02 39 23 14-39
info@hach-lange.it
www.hach-lange.it

HACH LANGE S.L.U.

Edif. Arteaga Centrum
C/Larrauri, 1C- 2ª Pl.
E-48160 Derio/Vizcaya
Tel. +34 94 657 33 88
Fax +34 94 657 33 97
info@hach-lange.es
www.hach-lange.es

HACH LANGE LDA

Av. do Forte nº8
Fracção M
P-2790-072 Carnaxide
Tel. +351 214 253 420
Fax +351 214 253 429
info@hach-lange.pt
www.hach-lange.pt

HACH LANGE SP.ZO.O.

ul. Opolska 143 a
PL-52-013 Wrocław
Tel. +48 (0)71 342 10-83
Fax +48 (0)71 342 10-79
info@hach-lange.pl
www.hach-lange.pl

HACH LANGE S.R.O.

Lešanská 2a/1176
CZ-141 00 Praha 4
Tel. +420 272 12 45 45
Fax +420 272 12 45 46
info@hach-lange.cz
www.hach-lange.cz

HACH LANGE S.R.O.

Roľnícka 21
SK-831 07 Bratislava –
Vajnory
Tel. +421 (0)2 4820 9091
Fax +421 (0)2 4820 9093
info@hach-lange.sk
www.hach-lange.sk

HACH LANGE KFT.

Hegyalja út 7-13.
H-1016 Budapest
Tel. +36 (06)1 225 7783
Fax +36 (06)1 225 7784
info@hach-lange.hu
www.hach-lange.hu

HACH LANGE S.R.L.

Str. Leonida, nr. 13
Sector 2
RO-020555 Bucuresti
Tel. +40 (0) 21 201 92 43
Fax +40 (0) 21 201 92 43
info@hach-lange.ro
www.hach-lange.ro

HACH LANGE

8, Kr. Sarafov str.
BG-1164 Sofia
Tel. +359 (0)2 963 44 54
Fax +359 (0)2 866 04 47
info@hach-lange.bg
www.hach-lange.bg

HACH LANGE SU ANALİZ SİSTEMLERİ LTD.ŞTİ.

Hilal Mah. 75. Sokak
Arman Plaza No: 9/A
TR-06550 Çankaya/ANKARA
Tel. +90 (0)312 440 98 98
Fax +90 (0)312 442 11 01
bilgi@hach-lange.com.tr
www.hach-lange.com.tr

HACH LANGE D.O.O.

Fajfarjeva 15
SI-1230 Domžale
Tel. +386 (0)59 051 000
Fax +386 (0)59 051 010
info@hach-lange.si
www.hach-lange.si

HACH LANGE E.Π.E.

Αυλίδος 27
GR-115 27 Αθήνα
Τηλ. +30 210 7777038
Fax +30 210 7777976
info@hach-lange.gr
www.hach-lange.gr

HACH LANGE E.P.E.

27, Avlidos str
GR-115 27 Athens
Tel. +30 210 7777038
Fax +30 210 7777976
info@hach-lange.gr
www.hach-lange.gr